

HPTO System Components

Product Specification Sheet

Filter Assembly



Filter Assembly



PT Tech p/n:	CHYFA-001-D
Manufacturer:	Donaldson
Manufacturer p/n:	P17-0773 Head P17-0311 Filter P17-0926 Electrical Indicator
Model:	HMK03 Series
Features:	Medium pressure industrial grade filter offering 16 μ absolute filtration. Filter head accepts spin-on filter, which requires changing after electrical indicator registers a clogged filter. A minimum clearance of 1.69" must be given below filter bowl to allow for its removal when clogged.

Head Specifications	Size/Rating
Inlet Port	3/4" SAE O-ring
Outlet Port	3/4" SAE O-ring
Flow Range	0-25 gpm
Static Pressure	2000 psi
Working Pressure	1000 psi
Bypass Pressure	50 psi
Operating Temperature Range	-20° to 250° F

Filter Specifications	Size/Rating
Spin-on Filter	9.5" long
Absolute Micron Rating, B ₃ =75	16 μ

Electrical Switch Specifications	Size/Rating
Wiring	DC 2-wire
Switch condition	Normally CLOSED
Current draw (maximum)	100 mA @ 30 VDC
Trip Pressure	40 psid

Deutsch Connector Specifications:	
Receptacle	DT04-2P-E004
Wedgelock	W2P
(2) Pins	0460-202-16141

ASSEMBLY SIDE VIEW

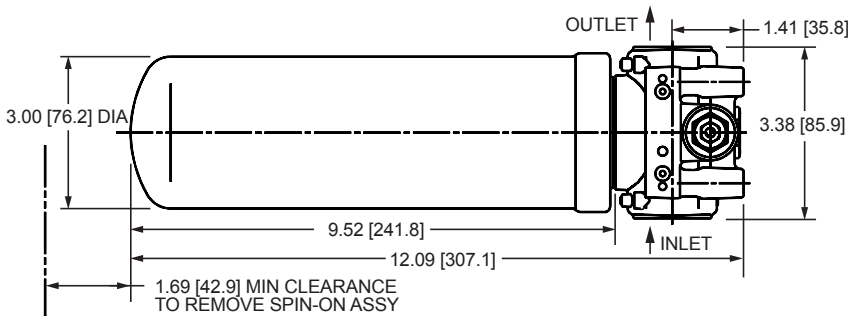

HEAD TOP VIEW

with DC Electrical Service Indicator

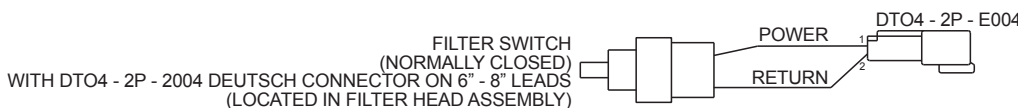
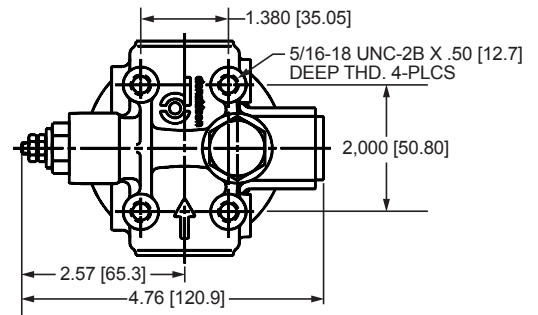

Storage:

Product should be stored in a dry area that has constant temperature.

Temperature changes in the storage area can cause condensation to form in inside the filter / housing. This condensation causes corrosion which could enter into the system.

The filter should be left in the factory packaging for as long as possible.

0-12 Months: Keep the filter in the factory packaging.

13-24 Months: Plug all connections air-proof. Pack the filter in a corrosion protection film.

After 24 Months: Inspect inside filter element and head for signs of corrosion. If corrosion is found, replace element and/or filter head.

Installation:

Mounting: The filter should be fastened to a rigid plate to prevent excessive vibration. Mounting the unit where the filter is below the filter head is the recommended position. The filter could be mounted sideways if needed.

The filter head should be mounted in a manner that prevents the sensor wires from being caught by rotating equipment or by flying debris.

Maintenance:

External Cleaning: Since the electrical sensor can be damaged during cleaning, high pressure washers are not recommended. Any corrosive substances should not be used.

Replace filter elements based on the clutch maintenance intervals as detailed in the I&M or when the indicator shows a plugged filter.



1441 Wolf Creek Trail • P.O. Box 305
Sharon Center, OH 44274
PT Tech USA: +1 330 239 4933
sales@pttech.com • www.pttech.com

UNITED KINGDOM OFFICE
16 Atlas Rd, Hermitage Industrial Estate
Coalville, Leicestershire, LE67 3FL
PT Tech UK: +011 44 7769 159-195

PT Tech is a subsidiary of
 **EBO Group**
Employee Owned Companies



ISO 2001:2008
with design